

Portable TV Speaker

with voice enhancement



USER'S MANUAL

!!! Please refer to our website: www.geemarc.com for an up-to-date user guide, as there may be important updates and changes you need to be aware of !!!

Important safety instructions

Normal operating temperature for the product (e.g. 0°C~40°C).

Use only the adapters and battery listed below.

⚠️ Power adapter information: output: 5V DC 2A, 10W. VTPL Model: VT07EEU05200 (EU), VT07EUK05200 (UK).

⚠️ Rechargeable Battery: Great Power, Model: INR21700-5000. 3.6V, 5000mAh Li-ion, 18Wh.

Note on rechargeable Lithium-Ion batteries

This device uses a rechargeable lithium-ion battery. Misuse or improper use can result in battery damage! In extreme cases, there is a risk of explosion, fire, or the development of heat, smoke or gases.

- Rechargeable batteries must not be exposed to excessive heat such as sunlight, fire or the like.
- Do not touch the battery with your bare hands if it leaks or has been damaged. Leaking liquid can cause skin irritation and other injuries.
- If you do not use the device for a longer period of time, charge it every six months to maintain the integrated rechargeable battery in good condition.
- Do not remove the rechargeable battery in the charged state from the device. Do not short-circuit it, dismantle it or deform it.
- If the device is obviously faulty, do not recharge the battery. Terminate the charging process if the device becomes excessively hot.
- Observe the warranty and disposal instructions.

Safe Removal and Disposal of rechargeable battery from TV speaker

This device uses a lithium-ion battery that has to be disconnected from the obsolete product to ensure proper recycling of materials.

geemarc™
Hear the Difference
SONARYA

Warning: Only remove the rechargeable battery for disposal of the device. Make sure that the battery is completely discharged before removing it. We strongly recommend you get help from a qualified electrician to removing the battery.

- You need a Phillips screwdriver and a flathead screwdriver to remove the rechargeable battery. Observe the basic safety procedures when performing the steps listed below.
 - Protect your eyes, hands and fingers and the surface on which you are working. Pay attention to breaking or flying parts when removing the battery - risk of injury.
 - Wear protective goggles.
1. To completely discharge the battery, remove the TV speaker from the base. Switch the TV Speaker on and let it run until it enters standby. Repeat this process until you can no longer switch the TV Speaker back on.
 2. Take a Flathead screwdriver and remove the speaker cover on the back by pushing the screwdriver between the surrounding rubber covering and the fabric-covered speaker cover.
 3. Undo the eight screws of the battery compartment with a screwdriver. Then push the screwdriver away from the housing to detach the speaker cover. You might have to repeat this process on several sides to detach the cover.
 4. Disconnect plug connections of the electronic card.
 5. Carefully pull the battery out of the housing by the plug connection cable.
 6. The rechargeable battery and the remainder of the product can now be recycled and properly disposed of.

Disposing of used disposable and rechargeable battery

Make sure that disposable and rechargeable battery is properly disposed of. Dispose of the product by taking it to a suitable collection site for the recycling of electrical and electronic devices.

What's in the box

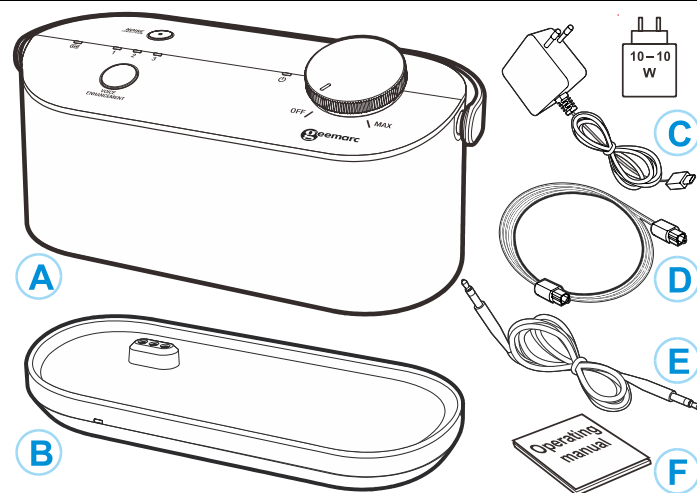

- A. TV speaker (Note: You can register up to 3 TV speakers to the base.)
 B. Base station (transmitting / charging station)
 C. USB type C power adapter
 D. Optical audio cable (Toslink 48 kHz 16 bit PCM)
 E. 3.5mm audio cable
 F. User's manual

Overview - TV speaker and base

TV speaker overview

1. **NOISE CANCELLATION** key with indicator
 - Press to reduce background noises. The blue indicator light will turn on.

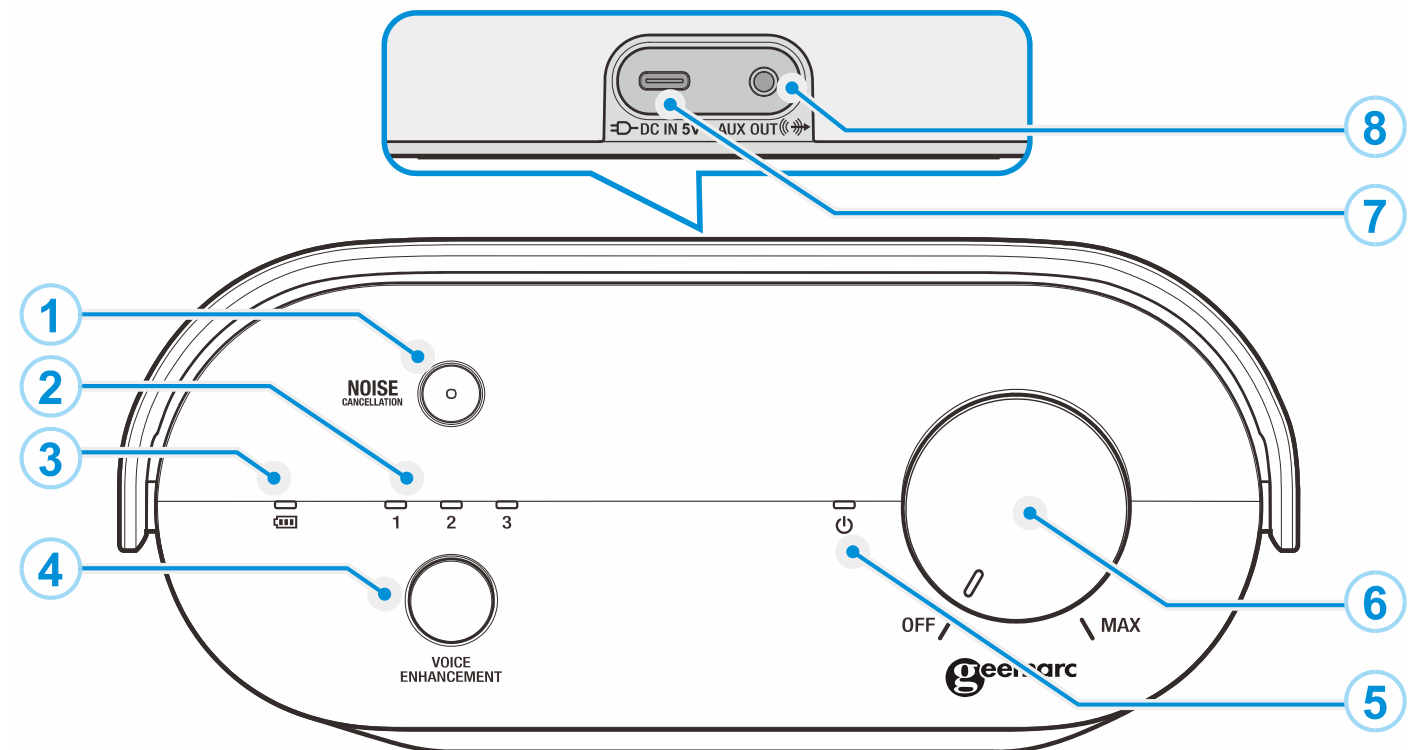

- Press again to turn off. The indicator light will go out.
 - Press the key for 5 seconds to pair the TV speaker on his base.
2. **1 / 2 / 3** (Voice enhancement indicator)
 - On when voice enhancement level 1, 2 or 3 is selected.
 3. (Battery level indicator)
 - **Amber** during charging.
 - **Green** when the battery is fully charged.
 - **Red** when battery level is low and needs charging.
 - **Off** when battery is empty or when the TV speaker is not connected to power supply.
 4. **VOICE ENHANCEMENT** key
 - Press to toggle among the 3 levels of voice enhancement or turn it off.
 5. (Power and connection indicator)
 - On when the TV speaker is powered on.
 - Flashes green rapidly when pairing to the base.
 - Flashes green slowly when out of range from the base.
 6. **OFF / MAX** knob (On / Off / Volume knob)
 - Turn clockwise to turn on the TV speaker and to increase the TV speaker volume.
 - Turn anticlockwise to turn down the volume or turn off the TV speaker.
 7. **DC IN** (USB-C power jack)
 - Connect to power with the supplied USB-C cable.
 8. **AUX OUT** (3.5mm audio output jack)
 - Connect to headphones.

Base overview

9. **Power and connection indicator**
 - Steady white when the base is paired to the TV speaker.
 - Flashes white rapidly when pairing.
 - Flashes white slowly when the TV speaker is not paired to the base.
 - Dims when the base is in power saving mode.

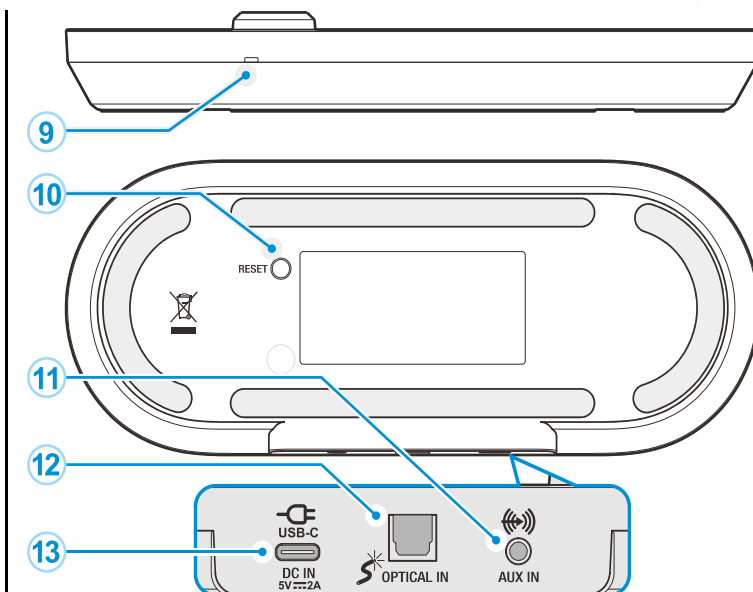

10. **RESET** key
 - Reset the TV speaker to its factory default settings.
11. **AUX IN** (3.5mm audio input jack)
 - Connect the supplied audio cable to AUX IN on the base and your TV 3.5mm audio out.
12. **OPTICAL IN**
 - Connect the supplied optical cable to the OPTICAL IN on the base and your TV optical audio out.
13. **DC IN** (USB-C power jack)
 - Connect to the supplied power adaptor with the supplied USB-C cable.

Installation and battery charging

Place the base on a flat, stable surface near your TV. Fully charge your TV speaker before using it for the first time.

NOTE: The battery is fully charged after 4 hours of continuous charging.

CONNECT THE BASE TO POWER SUPPLY

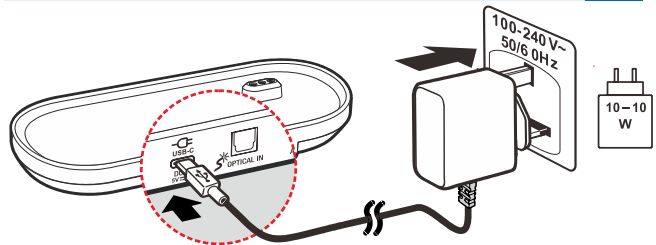

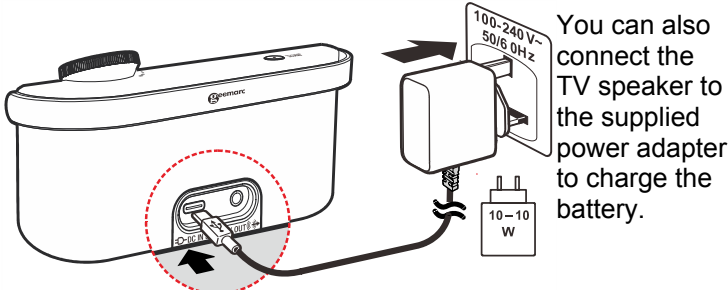

1. Connect the supplied USB-C charging cable to supplied power adaptor and the **DC-IN**  jack on the base. Plug the power adaptor in to a nearby switched electrical main outlet socket.
2. Place the TV speaker onto the base to charge the battery.

CONNECT TV SPEAKER TO POWER SUPPLY



You can also connect the TV speaker to the supplied power adaptor to charge the battery.

BATTERY LEVEL INDICATOR

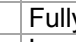
	Amber	Charging
	Green	Fully charged
	Red	Low battery (less than 20%)

Setup

The SONARYA TV speaker with noise cancellation to reduce ambient background sounds on TV programs and voice enhancement for clearer speech. There are two ways to connect the speaker to your TV: Optical Audio and 3.5mm Audio cable.

CONNECT TO TV WITH OPTICAL AUDIO CABLE

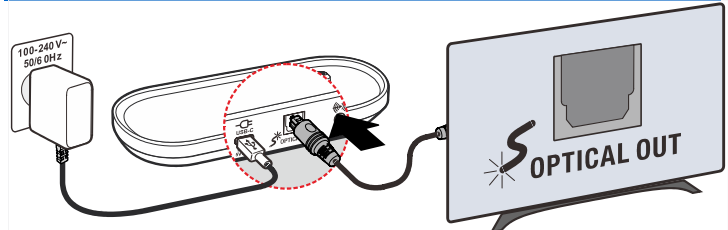

1. Carefully remove the protective covers at each end of the OPTICAL audio cable.
2. Plug one end of the cable to the base and the other to the OPTICAL OUT on your TV. Firmly plug in the connectors until they lock into place.
3. Change your TV digital audio setting to PCM output. If the audio is not set to PCM, you may not hear any sound. For information on how to set the digital audio output to PCM, refer to the operation manual of your TV.

CONNECT TO TV WITH 3.5MM AUDIO CABLE

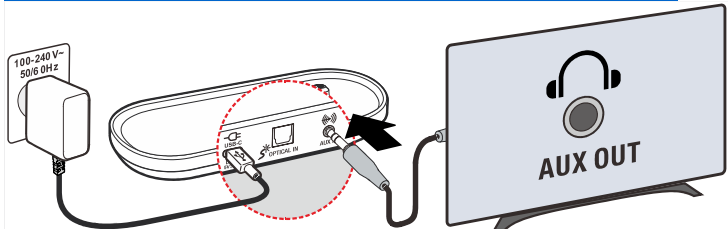

Connect one end of the 3.5mm audio cable to AUX IN on the

base and to the other to your TV's audio output (AUX OUT or headphones jack). Firmly plug in the connector.

Note: Refer to the operation manual of your TV for more information on audio output connection and the necessary changes to the TV audio settings.

LISTEN WITH HEADPHONES



⚠ HEARING SAFETY CAUTION:

- Before you use headphones, decrease the TV speaker volume to protect your hearing from sudden loud sound.
- Loud sound may damage your hearing. If the speaker is too loud, set the volume to a lower level.

Operation

LISTEN TO TV AUDIO

Remove TV speaker from the base before turning it on.

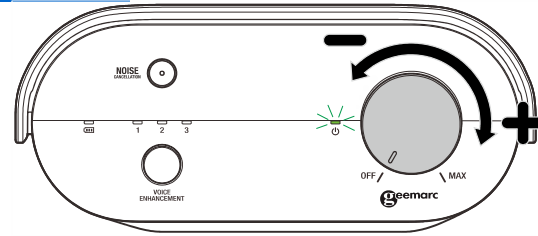

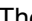
- To turn on TV speaker, rotate the On / Off / Volume knob clockwise from the **OFF** position until you hear a click. The  indicator lights up.
- To turn off TV speaker, rotate the On / Off / Volume knob anticlockwise toward the **OFF** position until you hear a click. The  indicator goes out.

VOLUME

To increase the volume, rotate the On / Off / Volume knob clockwise. To reduce the volume turn it anticlockwise.

- **MAX** position is the highest volume setting.

NOISE CANCELLATION

Press the **NOISE CANCELLATION** key to reduce background noise on TV programs.

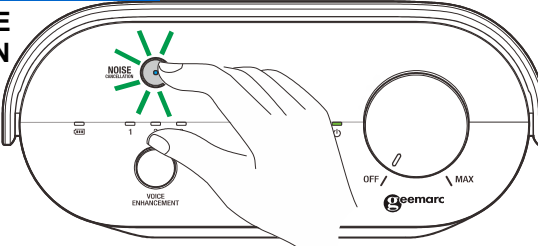

VOICE ENHANCEMENT

You can select from 3 levels of voice enhancement to improved clarity of speech on TV programs.

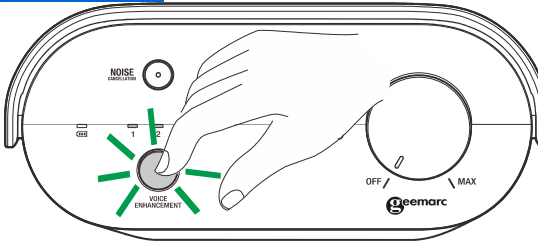

- Press the **VOICE ENHANCEMENT** key to toggle between the 3 levels or to turn it off. The respective indicator lights 1, 2 or 3 turns on when selected.

TIP: We recommend that you sample each level and select the one that is clearest.

NOTE: The TV speaker is suitable for people with mild to moderate hearing loss. The general audio quality may change when the voice enhancement feature is on.

Pairing / Reset

Unpair all TV speakers

You can reset the TV speaker system if it has some abnormal behavior, like no sound at all. All TV speaker paired to the base will be unpaired.

1. Make sure the base is unplugged from the power outlet.
2. While you **press and hold** the **RESET** key on the base, plug the base back to the power outlet.
 - The power and connection indicator turns on and flashes slowly.
3. After about 10 seconds when the power and connection indicator flashes quickly, release the **RESET** key.
4. After 10 seconds, reset the power of the base.
 - The power and connection indicator turns on and starts flashing slowly when all TV speakers are unpaired successfully from the base.



Reset a TV speaker

- If your TV speaker does not have a connection to the base, press **NOISE CANCELLATION** key for 5 seconds until the  indicator on the TV speaker turns off. After some seconds, all the LEDs (1-2-3 and ON/OFF) start to blink.

Pair a TV speaker to the base

Your TV speaker is already paired to the base. If you have unpaired the TV speaker or have purchased additional TV speaker, pair it to the base as below. You can pair up to 3 TV speaker to the base.

Turns on then place the TV speaker onto the base to pair it with the base.

- When pairing, the  indicator on the TV speaker flashes green rapidly.
- When paired, you hear a beep sound and both  indicator and the **power and connection indicator** on the TV speaker become steady on.

Troubleshooting

If you have difficulty with your TV speaker, please try the suggestions below.

TV speaker does not play the audio.

- The battery level may be low Fully charge the battery.
- Make sure that 3.5mm audio cable or the optical cable is firmly connected to then base and the TV.
- Make sure the TV speaker is paired to the base. If necessary, reset the TV speaker following the steps in "RESET TV SPEAKER" section.
- The TV speaker may be too far from the base (out of range). Move the TV speaker closer to the base.

The TV audio fails frequently.

- Devices, such as smart phones, Wi-Fi and microwave ovens may cause interference to your TV speaker. Try placing your TV speaker as far away as possible from these devices.

There is interference when listening to TV audio.

- The 3.5 mm audio cable may not be connected correctly. Firmly connect the audio cable to the TV and the base.

General product care

To keep your TV speaker working well and looking good, follow these guidelines:

- Avoid putting it near heating appliances and devices that generate electrical noise (for example, motors or fluorescent lamps).

- Do not expose it to direct sunlight or moisture.
- Avoid dropping the product or treating it roughly.
- Clean with a soft cloth.
- Never use a strong cleaning agent or abrasive powder as this may damage the finish.
- Retain the original packaging in case you need to ship it at a later date.

Technical Specifications

Frequency control	Crystal controlled PLL synthesizer
Transmit frequency	1.88 GHz to 1.9 GHz
Channels	10
Nominal effective range	Actual operating range may vary according to environment conditions at the time of use.
Power requirement	3.7V Rechargeable Li-ion battery. Input 100-240V AC 50/60Hz Output 5V DC 2.0A, 10.0W
RF power	< 250 mW
Power consumption	Base power consumption: Off mode:<1.5 W / Network standby mode:<2 W

GUARANTEE

From the moment your Geemarc SONARYA is purchased, Geemarc guarantee is for the period of two years. During this time, all repairs or replacements (at our discretion) are free of charge. Should you experience a problem then contact our help line or visit our website at www.geemarc.com.

The guarantee does not cover accidents, negligence or breakages to any parts. The product must not be tampered with or taken apart by anyone who is not an authorized Geemarc representative.

The Geemarc guarantee in no way limits your legal rights.

IMPORTANT: YOUR RECEIPT IS PART OF YOUR GUARANTEE AND MUST BE RETAINED AND PRODUCED IN THE EVENT OF A WARRANTY CLAIM.

Please note: The guarantee applies to the United Kingdom only.

DECLARATIONS:

CE & UKCA Directives

Geemarc Telecom SA hereby declares that this SONARYA is in compliance with the essential requirements and other relevant provisions of the Radio Equipment Directive 2014/53/UE.

The CE & UKCA declaration of conformity may be consulted at www.geemarc.com

Recycling Directives

The WEEE (Waste Electrical and Electronic Equipment) has been put in place for the products at the end of their useful life are recycled in the best way.

When this product is finished with, please do not put it in your domestic waste bin. Please use one of the following disposal options:

- Remove the batteries and deposit them in an appropriate WEEE skip.

Deposit the product in an appropriate WEEE skip.

- Or, hand the old product to the retailer. If you purchase a new one, they should accept it.

Thus if you respect these instructions you ensure human health and environmental protection.



For product support and help visit our website at www.geemarc.com
E-mail: help@geemarc.com telephone **01707 387602**

lines are open from 10:00-12:00 then 13:00-14:30 from Mon. to Fri.
Parc de l'Etoile, 2 Rue Gaillee, 59760 Grande-Synthe, France

Made for Geemarc Telecom S.A. in China

QUGSONARYA_En_A3_V0.6